

 Recambios RTH-30L-38 ed.01 (03-07) R-410 A 662043003
 Spare Parts RTH-30L-38 ed.01 (03-07) R-410 A 662043003
 Pièces détachées RTH-30L-38 ed.01 (03-07) R-410 A 662043003



1/7

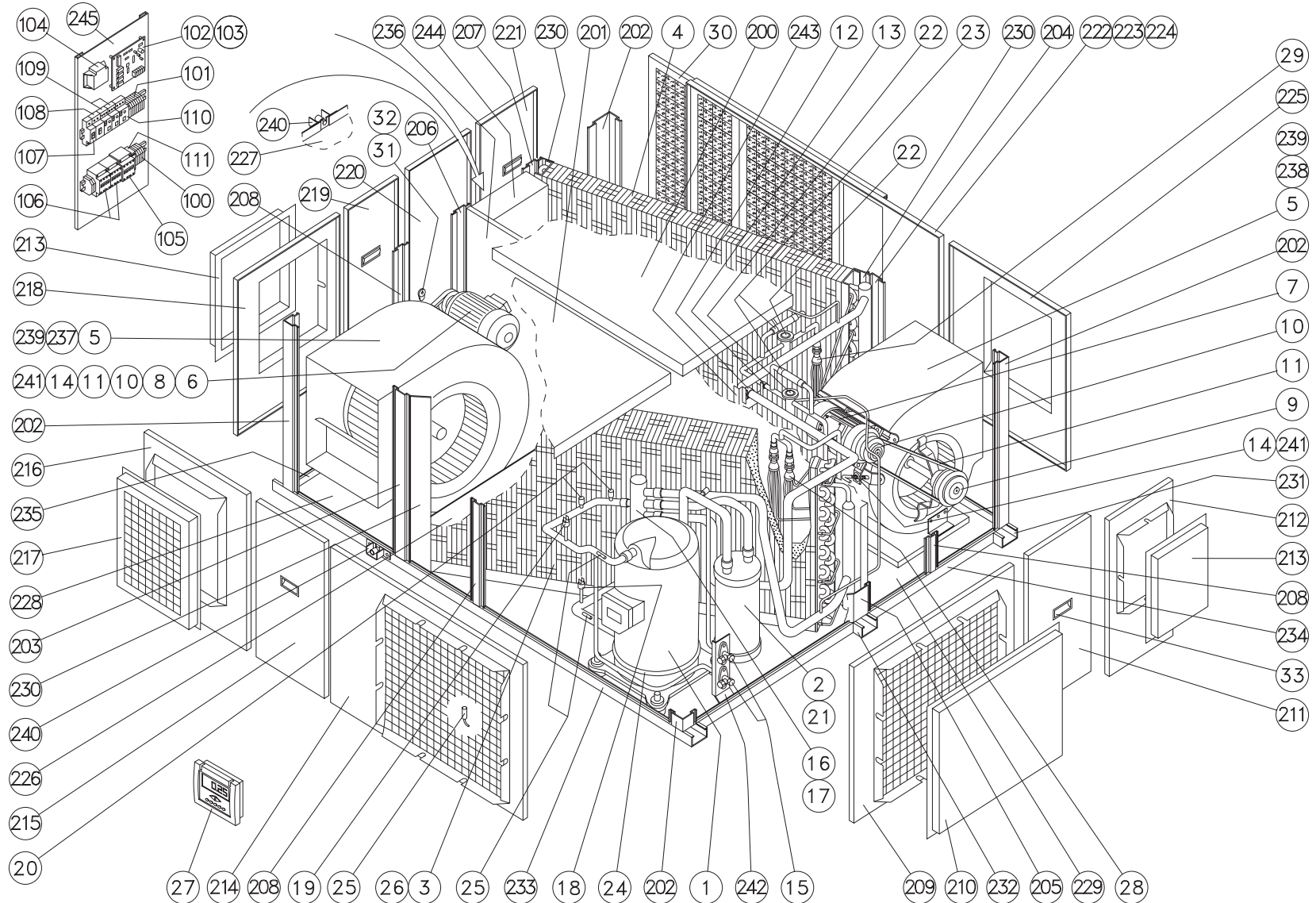

POS	ITEM	DENOMINATION	QUANTITY
			RTH-30L-38 ed.01
			662043003
1	003721915	Compressor	1
2	001999571	Suction accumulator	1
3	61-9521	Condenser coil	1
4	61-9524	Evaporator coil	1
5	003795052	Centrifugal fan	2
6	006792530	Fan motor	1
7	006792525	Fan motor	1
8	003761027	Fan pulley	1
9	003761068	Fan pulley	1
10	003761031	Speed variating pulley	2
11	004918098	Fan belt	2
12	003581512	Clamp	2
13	003581515	Clamp	2
14	003778542	Motor support	2
15	003794448	Two-way valve interconnection	2
16	003794367	Four-way valve	1
17	003708240	Four-way valve trip coil	1
18	003762927	Low pressure switch	1
19	003762926	High pressure switch	1
20	003515630	Access connection	4
21	003778511	Fixation rubber support	1
22	003794469	Expansion valve	2
23	003794381	One way valve	2
24	006824903	Compressor crankcase heater	1
25	003785064	3500 mm sensor	4
26	16-14997	Aluminium grid outdoor coil	1
27	003786044	Ambient thermostat (programmable)	1
28	022-08939-000	5/8" Distributor assembly with 7 pipes	2
29	022-08946-000	5/8" Distributor assembly with 8 pipes	1
30	003737736	Air filter 695 x 410 x 25	2
31	003719108	Handle	2
32	003719114	Push lock	2
33	003787101	Handle for handling	4
100	003770457	Power circuit connecting strip	1
101	003770455	Moving circuit connecting strip	1
102	006791210	Electronic board	1
103	006826810	Nylon separator	4
104	006849855	Transformer	1
105	006744652	Contacteur	1
106	006744617	Contacteur	2
107	006776814	Automatic switch	1
108	006776855	Main switch	1
109	006776700	Switch	2
110	006776840	Thermomagnetic switch	1
111	006745250	Phases control relay	1
200	66-9592	Indoor cover top Assy	1
201	66-9593	Outdoor cover top Assy	1
202	66-9502	Comer assembly	4
203	66-9597	Fan post assembly and outdoor coil	1
204	66-9603	Indoor coil fan post assembly	1
205	66-9599	Middle post assembly and outdoor coil	1
206	66-9513	Control box post assembly	1
207	66-9598	Control box post assembly	1
208	66-9503	Motor plate post assembly	3
209	66-9616	Outdoor coil panel assembly	1
210	66-9621	Air intake cover assembly	1

POS	ITEM	DENOMINATION	QUANTITY
			RTH-30L-38 ed.01 662043003
211	66-9601	Service pannel assy	1
212	66-9594	Fan panel assembly	1
213	66-9571	Fan grid cover assembly	2
214	66-9625	Outdoor coil panel assembly	1
215	66-9495	Indoor motor panel assembly	1
216	66-9596	Outdoor fan panel	1
217	17-14827	Outdoor air discharge panel	1
218	66-9595	Outdoor fan panel	1
219	66-9602	Outdoor motor panel assembly	1
220	66-9496	Control box panel	1
221	66-9612	Indoor coil panel assembly	1
222	62-9586	Filter frame panel assembly	1
223	17-14872	Upper filter guide	1
224	17-14873	Bottom filter guide	1
225	66-9604	Fan panel assembly	1
226	63-9588	Water Tray	1
227	63-9587	Drain pan assembly	1
228	66-9590	Metal base	1
229	66-9591	Metal base	1
230	17-14825	Coil bracket	4
231	18-14995	Indoor Base clamp crossbeam	1
232	18-14994	Central base clamp crossbeam	1
233	18-14996	Outdoor base clamp crossbeam	1
234	18-15037	Base clamp crossbeam	1
235	18-15038	Base clamp crossbeam	1
236	66-9606	Middle plate assembly	1
237	66-9600	Outdoor fan panel support	1
238	66-9605	Indoor fan panel support	1
239	17-14826	Fan support	2
240	11-6905	Drainpipe protection	2
241	11-14823	Fan tensioner support	2
242	17-14517	Valve support	1
243	17-14797	Tube support	2
244	66-9573	Control box assembly	1
245	17-14786	Components plate	1